

# CHAPTER 2

## SOME INPUT EXAMPLES

### 1. EXAMPLES OF INITIAL CONDITIONS

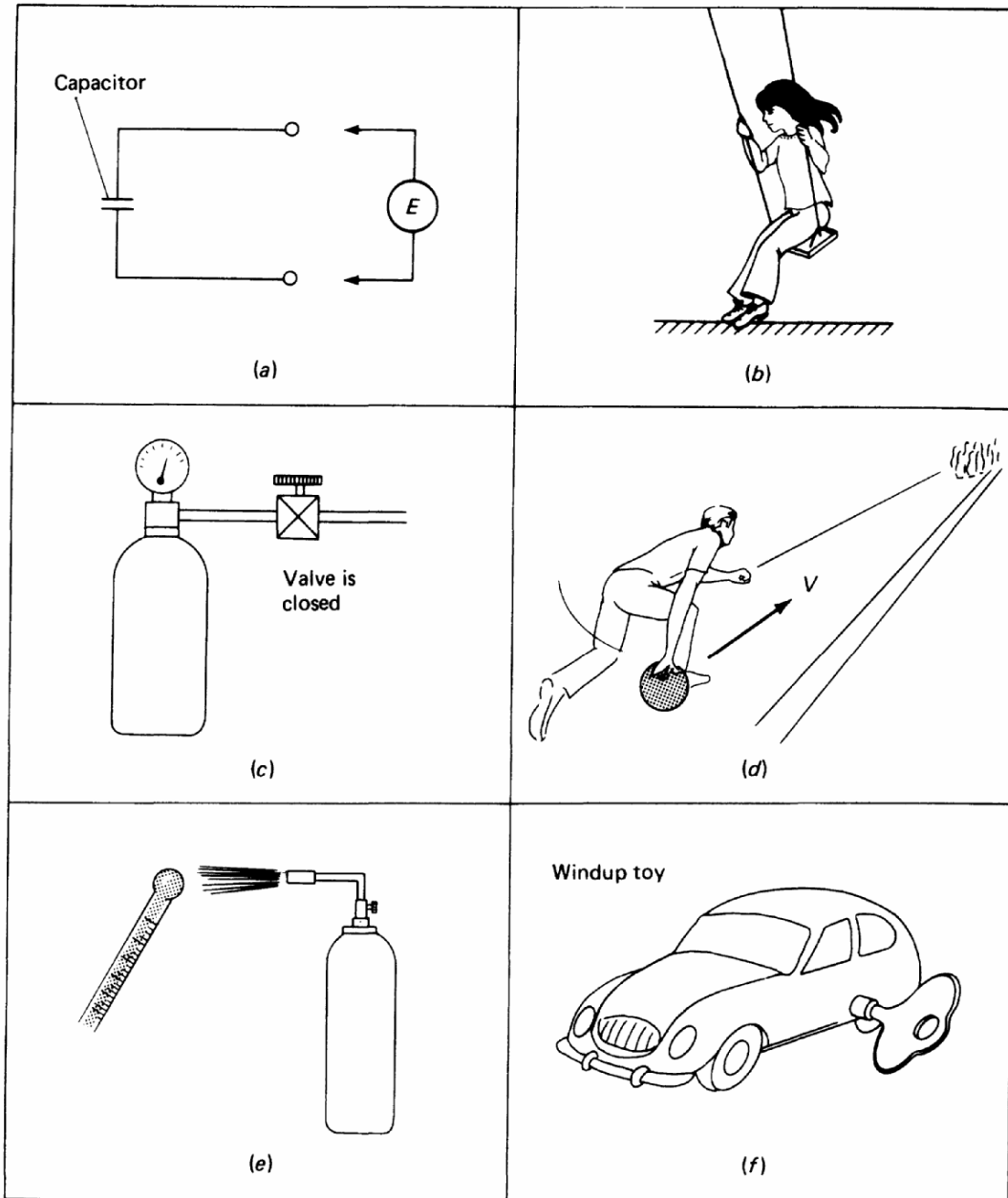

Figure 3.1.1-1 Some examples of initial conditions. (a) Initial charge. (b) Initial displacement. (c) Initial pressure. (d) Initial velocity. (e) Initial temperature. (f) Initial angular displacement.

## 2. EXAMPLES OF IMPULSE INPUTS

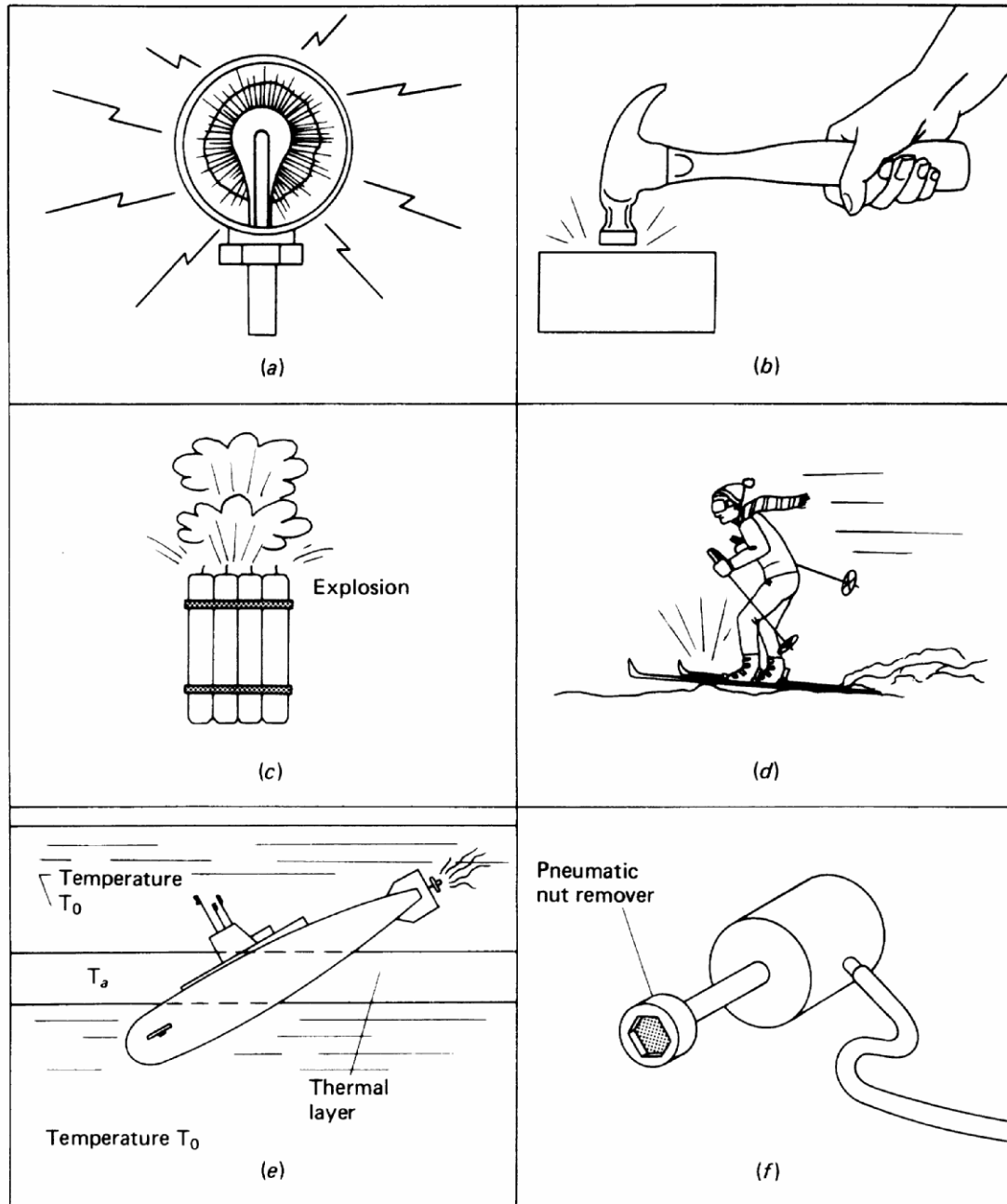

Figure 3.1.2-1 Some examples of impulse inputs. (a) Electronic flash gun. (b) Impulse force. (c) Impulse pressure. (d) Translatory impulse displacement. (e) Thermal shock. (f) Impulse torque.

### 3. EXAMPLES OF STEP INPUTS

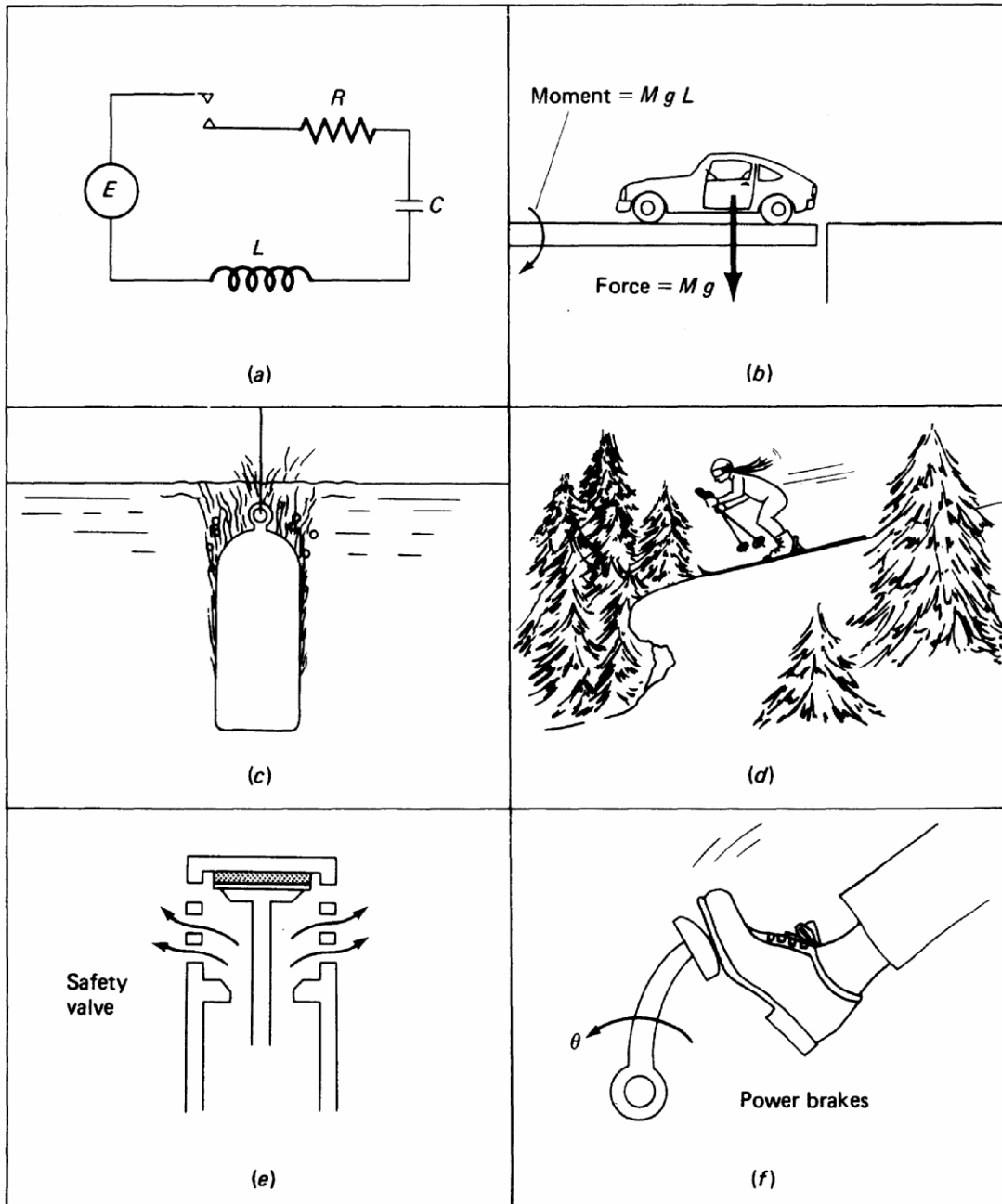

Figure 3.1.3-1 Some examples of step inputs. (a) Closing a switch. (b) Step force and step moment. (c) Quenching hot steel. (d) Translatory step displacement. (e) Step pressure. (f) Rotary step displacement.

#### 4. EXAMPLES OF RAMP INPUTS

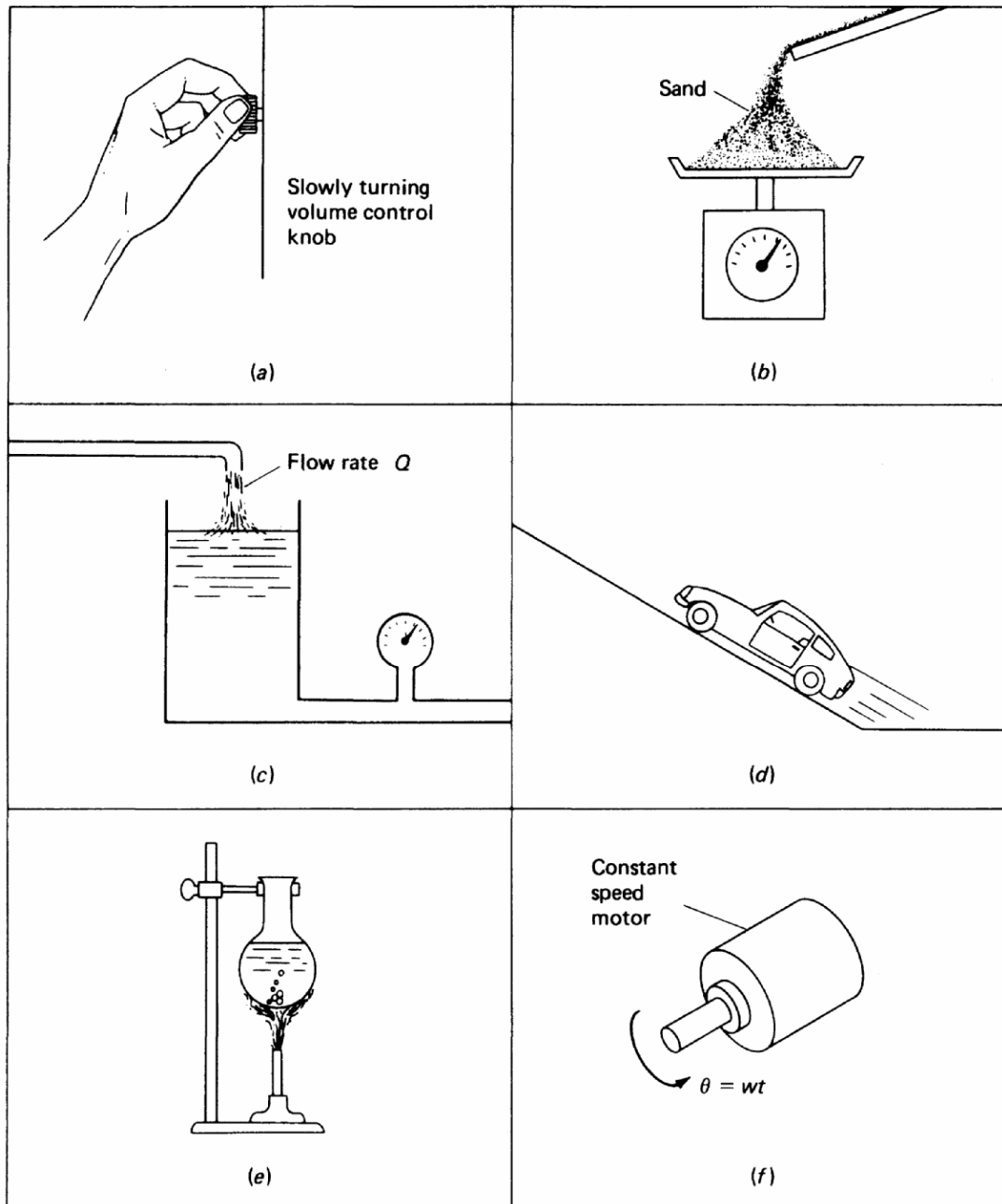

Figure 3.1.4-1 Some examples of ramp inputs. (a) Ramp voltage. (b) Ramp force. (c) Ramp pressure. (d) Translatory ramp displacement. (e) Constant temperature rise. (f) Rotary ramp displacement.