

Draw with scale (1:10), setion plan (X-X), elevation and S.V for the shown isometric view.

(N.B. Don't draw the isometric view and draw 3 bolts in each leg of angles with equal spacing)

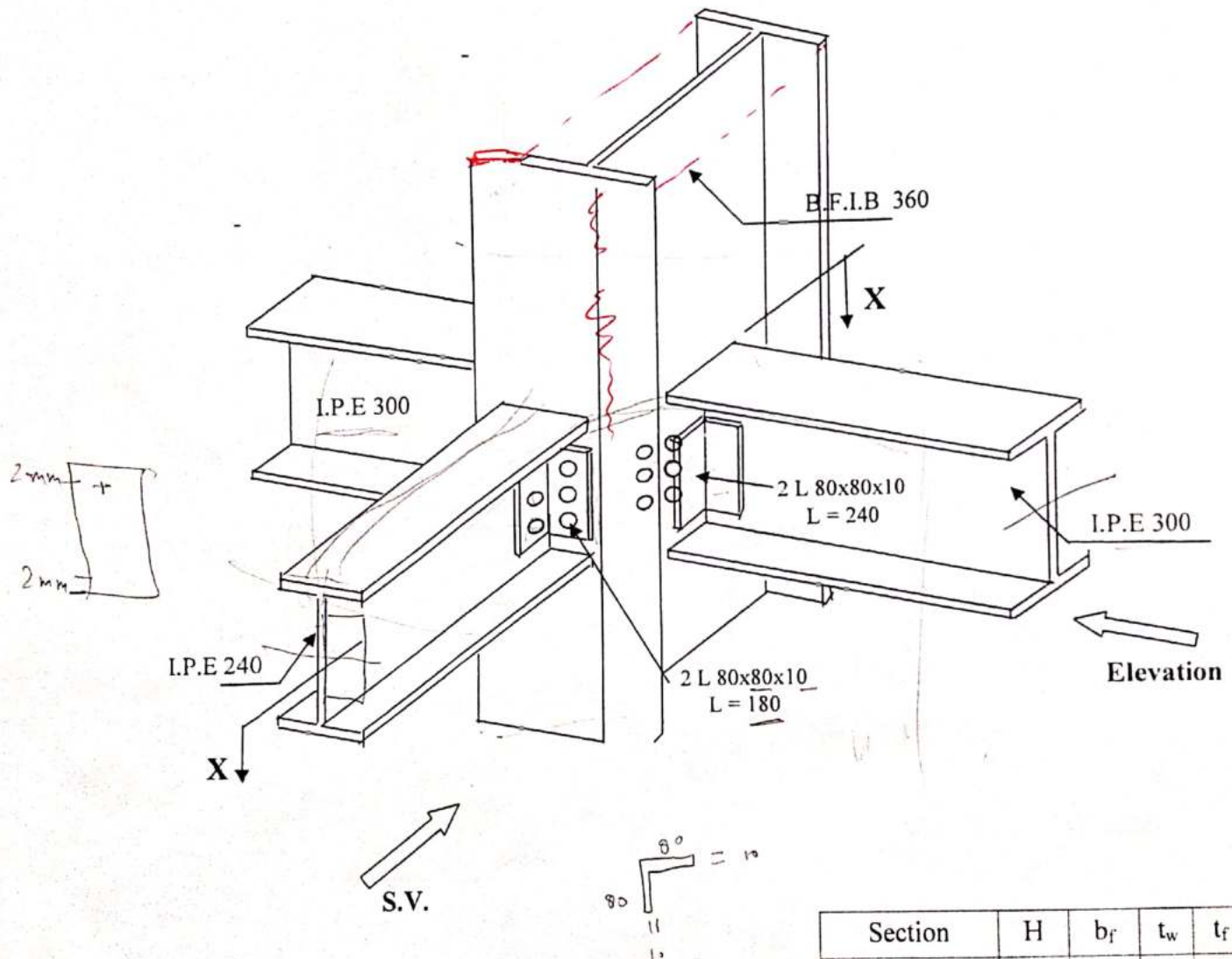

Section	H	b <sub>f</sub>	t <sub>w</sub>	t <sub>f</sub>
B.F.I.B 360	360	300	14	24
I.P.E 300	300	150	7	11
I.P.E 240	240	120	6	10

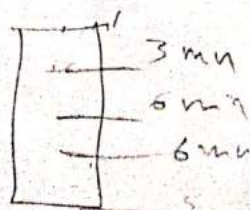

Draw with scale (1:10), setion plan (X-X), elevation and S.V for the shown isometric view.

(N.B. Don't draw the isometric view and draw 3 bolts in each leg of angles with equal spacing)

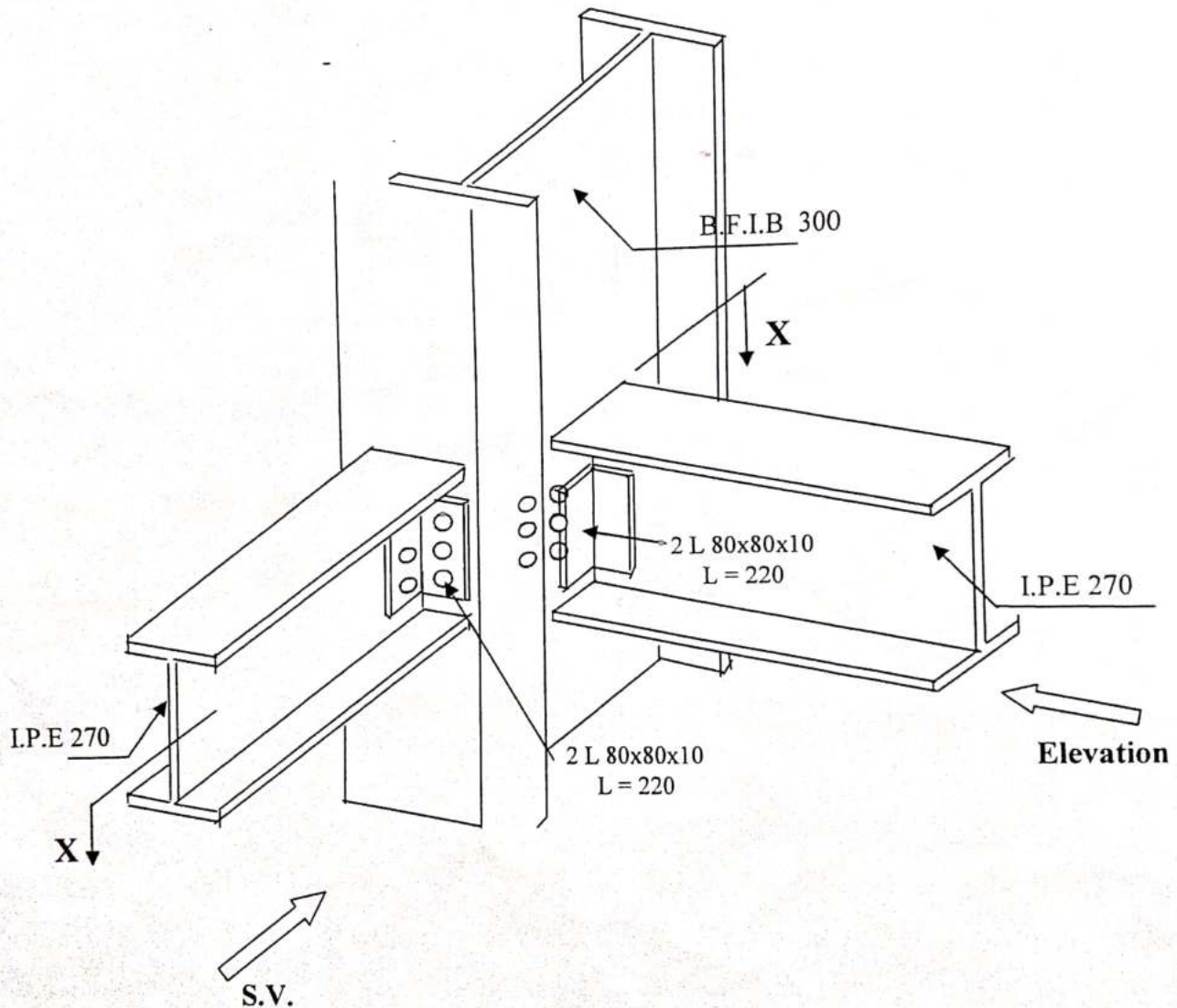

Section	H	b <sub>f</sub>	t <sub>w</sub>	t <sub>f</sub>
B.F.I.B 300	300	300	12	20
I.P.E 270	270	135	7	10

Draw with scale (1:10), plan , section plan (X-X), elevation and S.V for the shown isometric view. Diameter of the bolt is 16 mm and thickness of the tie plate is 14 mm.  
(N.B. Don't draw the isometric view)

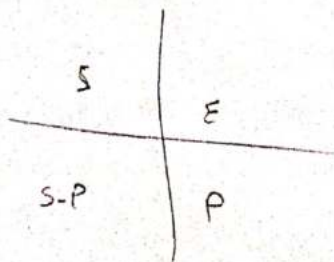
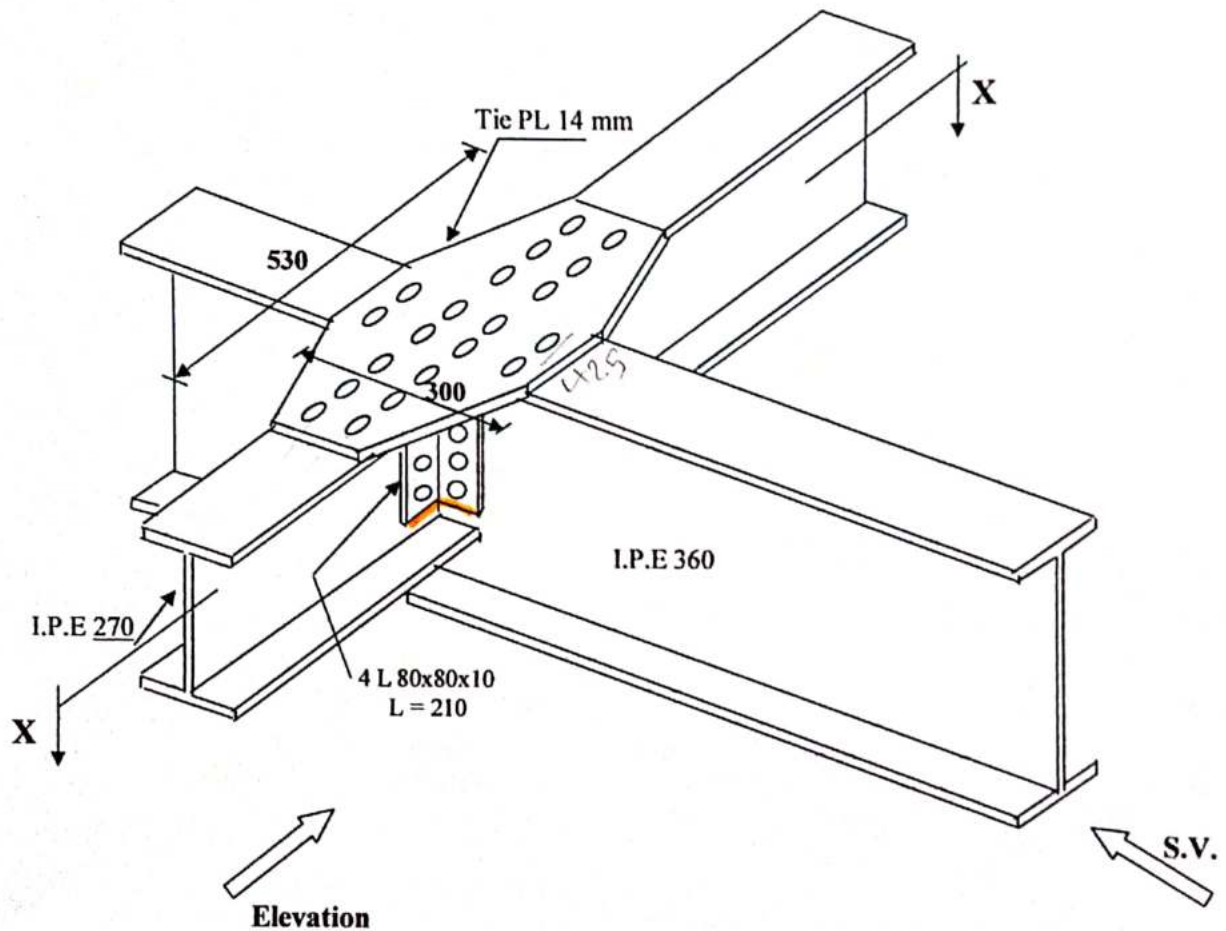

Section	H	b <sub>f</sub>	t <sub>w</sub>	t <sub>f</sub>
I.P.E 360	360	170	8	13
I.P.E 270	270	135	7	10

Draw with scale (1:10), plan , section plan (X-X), elevation and S.V for the shown isometric view. Diameter of the bolt is 16 mm and thickness of the tie plate is 16 mm.  
(N.B. Don't draw the isometric view)

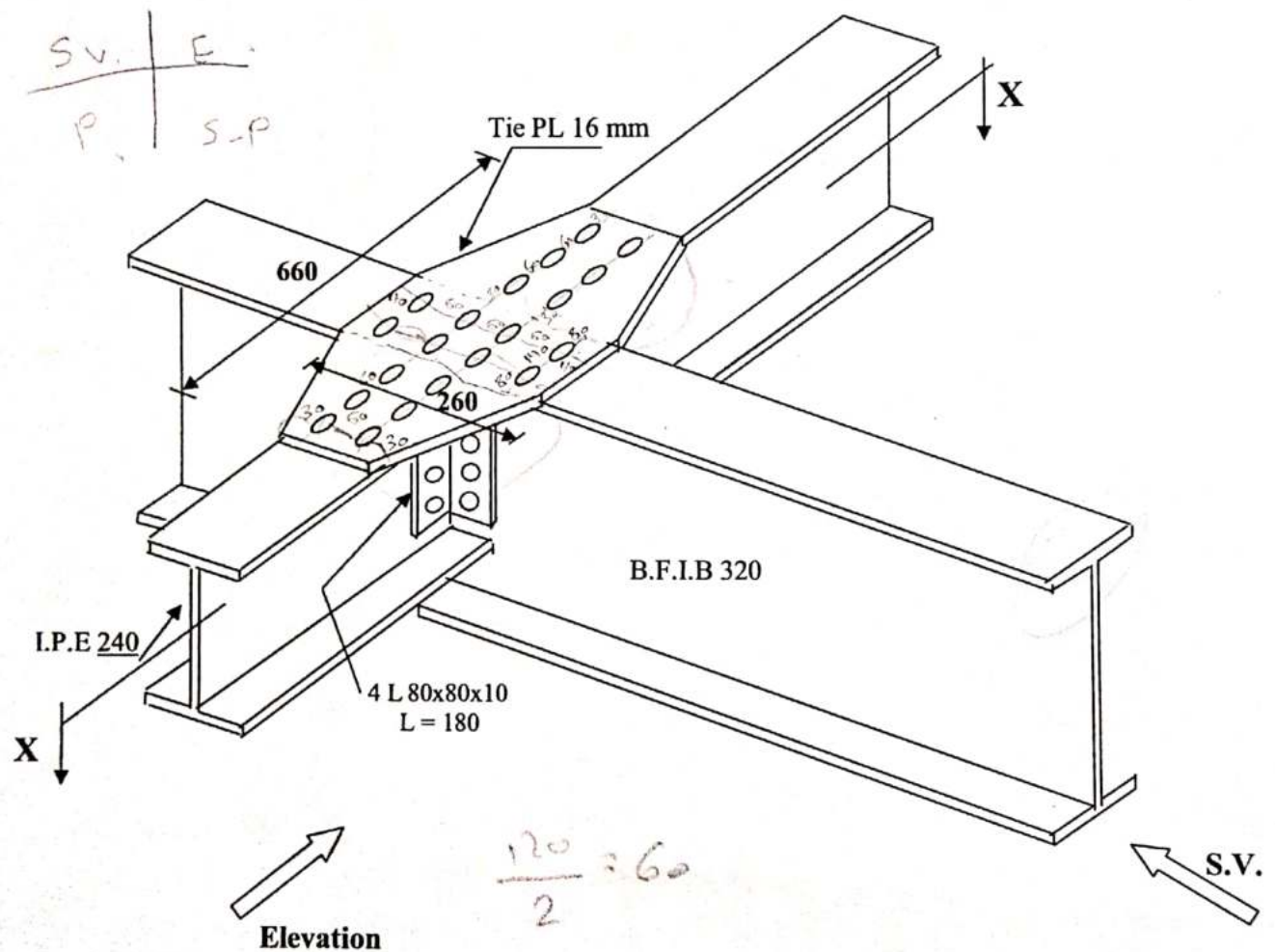

Section	H	b <sub>f</sub>	t <sub>w</sub>	t <sub>f</sub>
B.F.I.B 320	320	300	13	22
I.P.E 240	240	120	6	10

Draw with scale (1:10), setion plan (X-X), elevation and S.V for the shown isometric view.  
2 anchor bolts at each side of web is constructed with 100 mm spacing.

